

***For Your Convenience: This File Is
Shared By Diesel Parts Direct***



YOUR ONE STOP SUPERSTORE FOR DIESEL ENGINE PARTS

SHOP NOW

OPERATING INSTRUCTIONS

**Special Flange-Mounted Model
for Chrysler Marine Engine**
Series M-46-4 M-47-4

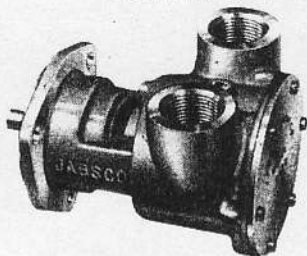

FEATURES

**BODY
BRONZE CONSTRUCTION**

**IMPELLER
SPECIAL NEOPRENE
COMPOUND**

SHAFT
316 STAINLESS STEEL

SHAFT SEAL
MECHANICAL LIP TYPE

BEARINGS
BALL BEARING

3/4" I.P.T. PORT SIZE

Approx. wt. 7 lbs.

INSTALLATION DRAWING

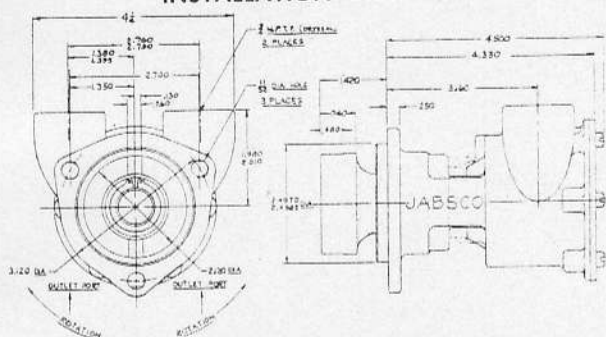

EXPLODED VIEW

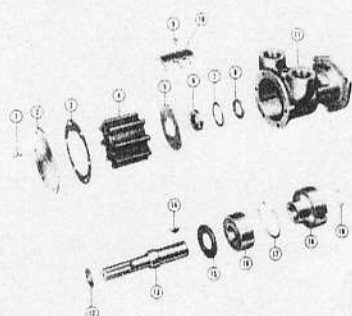

PARTS LIST

KEY	DESCRIPTION	QTY.	PART NUMBER
1	Screws—End Cover	6	SP 1003-01
2	End Cover	1	8175
3	Gasket	1	3101
4	Impeller	1	920-08
5	Wearplate	1	4156
6	Seal	1	SP 2700-06
7	"O" Ring	1	SP 2000-21
8	Spacer	1	3166
9	Screw—Cam	1	SP 1004-11
10	Cam	1	3255
11	Body	1	8174
12	Slinger	1	3286
13	Shaft	1	8177
14	Key	1	SP 1402-06
15	Bearing Seal	1	913
16	Ball Bearing	1	SP 2600-06
17	Retaining Ring	1	SP 1701-185
18	Coupling	1	8176
19	Retaining Ring	1	SP 1700-247

SERVICE KITS

MINOR SERVICE KIT—For "onboard" repairs — includes impeller, seal, gaskets and screws.

MAJOR SERVICE KIT—For major pump overhaul — includes all parts except body.

PART NUMBER	DESCRIPTION
8459	Minor Service Kit
8453	Major Service Kit

WARRANTY: All products of the company are sold and all services of the company are offered subject to the company's warranty and terms and conditions of sale, copies of which will be furnished upon request.

JABSCO® PUMP COMPANY
1485 DALE WAY • COSTA MESA, CALIF.